

142

123
142 143

142
162

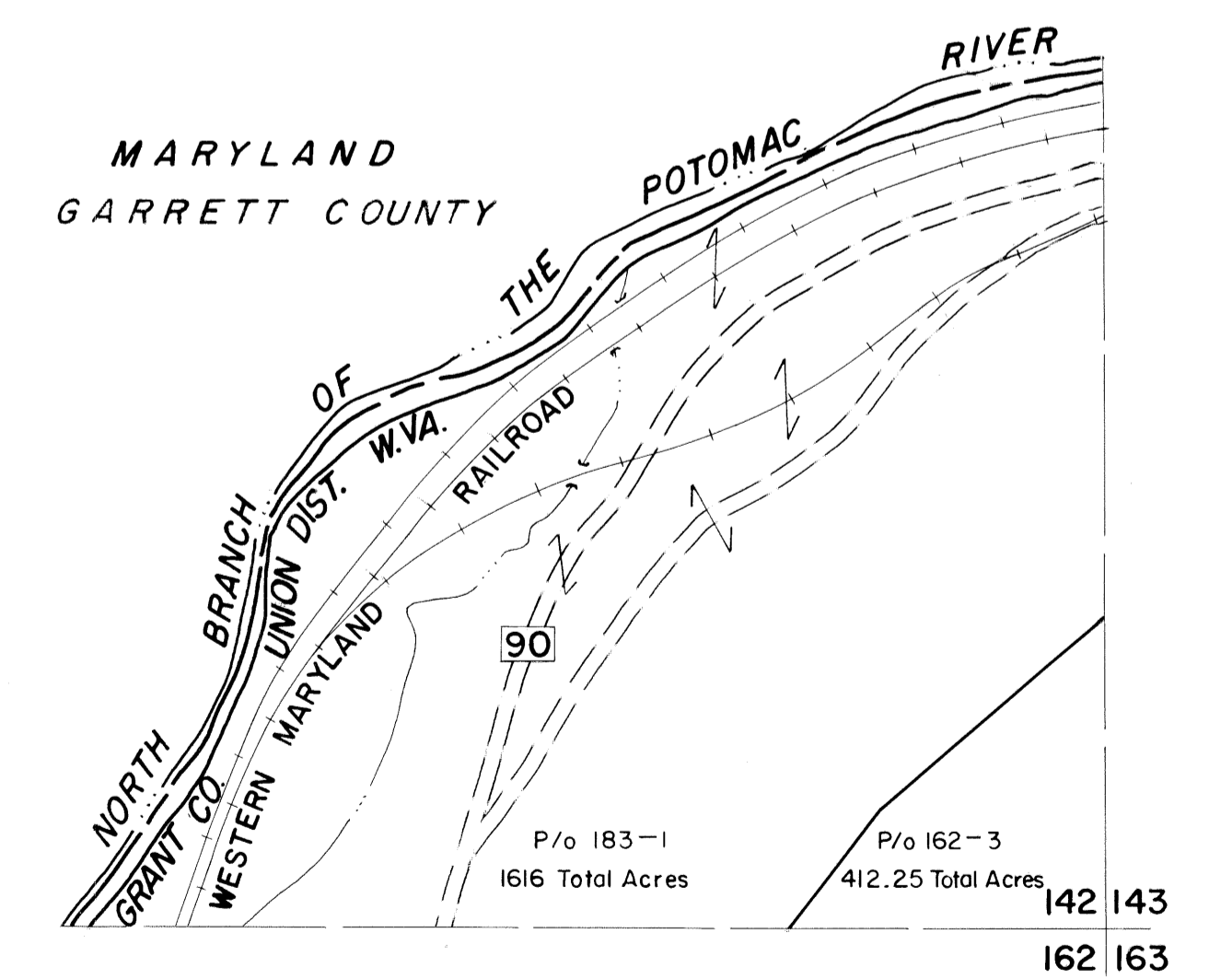

For Tax Purposes Only

Prepared by
MICHAEL BAKER, JR., INC.
Consulting Engineers
Rochester, Pennsylvania

Legend	
Property line	Original lot line
Edge of pavement or roadway	Deed lot number
Corporation line	Parcel or index number
District line	Improvement
County line	Railroad

Revisions			
1	REV. TO 7/81 DR. 3/82 NS	9	17
2	JULY, 1982	10	18
3	TRL	11	19
4		12	20
5		13	21
6		14	22
7		15	23
8		16	24

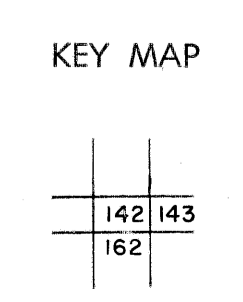

GRANT COUNTY
STATE OF WEST VIRGINIA
Office of Assessor

DISTRICT UNION

SHEET NO: 142

Date, Aerial Photography: Nov, 1961 Date, Map: Dec, 1962
Photo No: Scale: 1" = 400'