

137
142

137 138
142 143

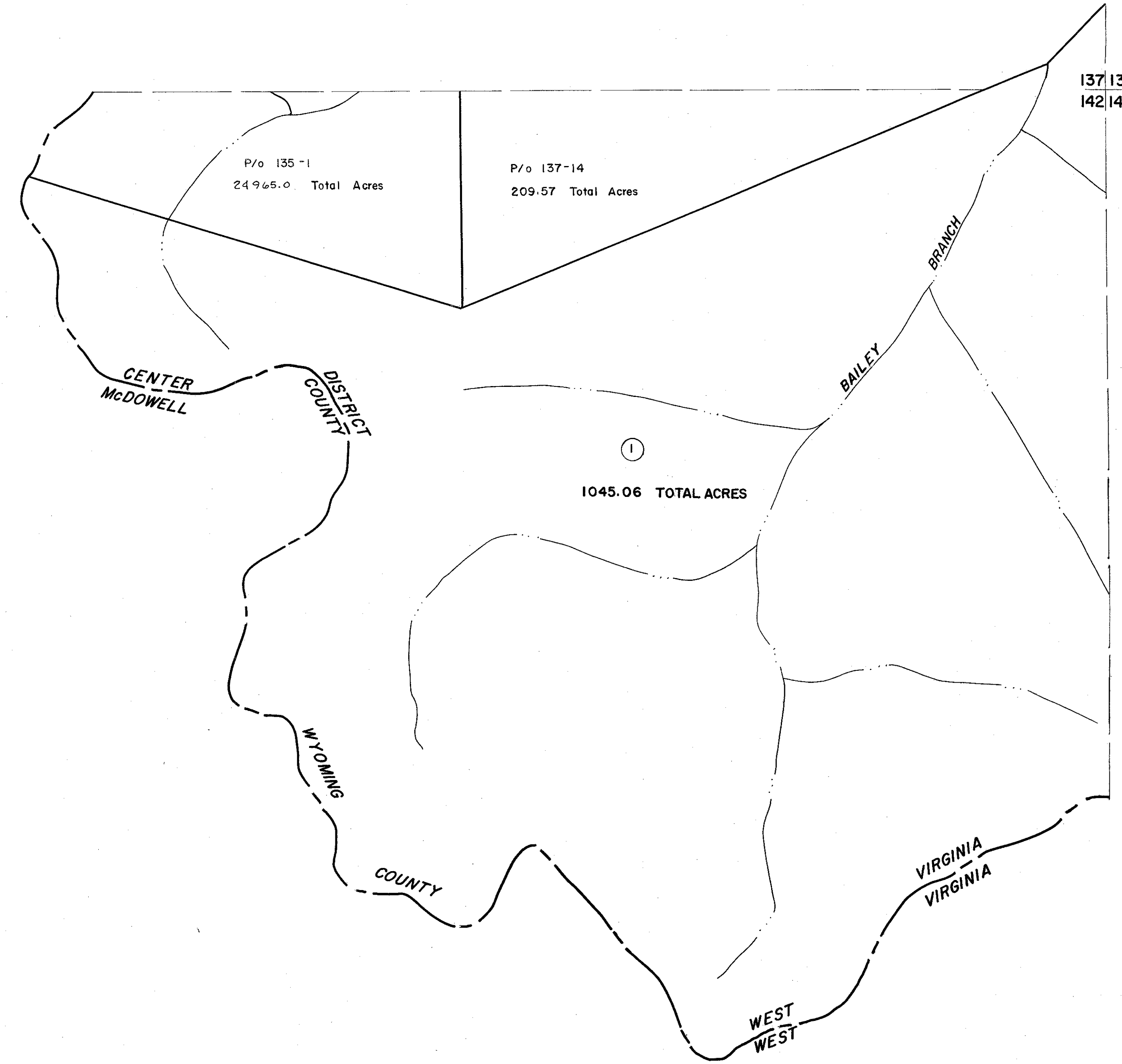

142

142 143

For Tax Purposes Only

Prepared by
MICHAEL BAKER, JR., INC.
Consulting Engineers
Rochester, Pennsylvania

Legend

Property line	—————	Original lot line	-----
Edge of pavement or roadway	=====	Deed lot number	(15)
Corporation line	-----	Parcel or index number	⊙
District line	-----	Improvement	○
County line	-----	Railroad	+++++

Revisions

1	3-1-64	9		17	
2	3/6/75	10		18	
3	Revised to 7-1-81	11		19	
4		12		20	
5		13		21	
6		14		22	
7		15		23	
8		16		24	

KEY MAP

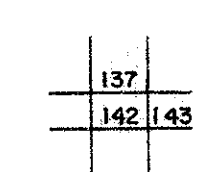

WYOMING COUNTY

STATE OF WEST VIRGINIA

Office of Assessor

DISTRICT

CENTER

SHEET NO: 142

Date, Aerial Photography November, 1962 Date, Map: April, 1963
Photo No: Scale: 1" = 400'