

143 | 144
| 147

144 | 145
147 | 148

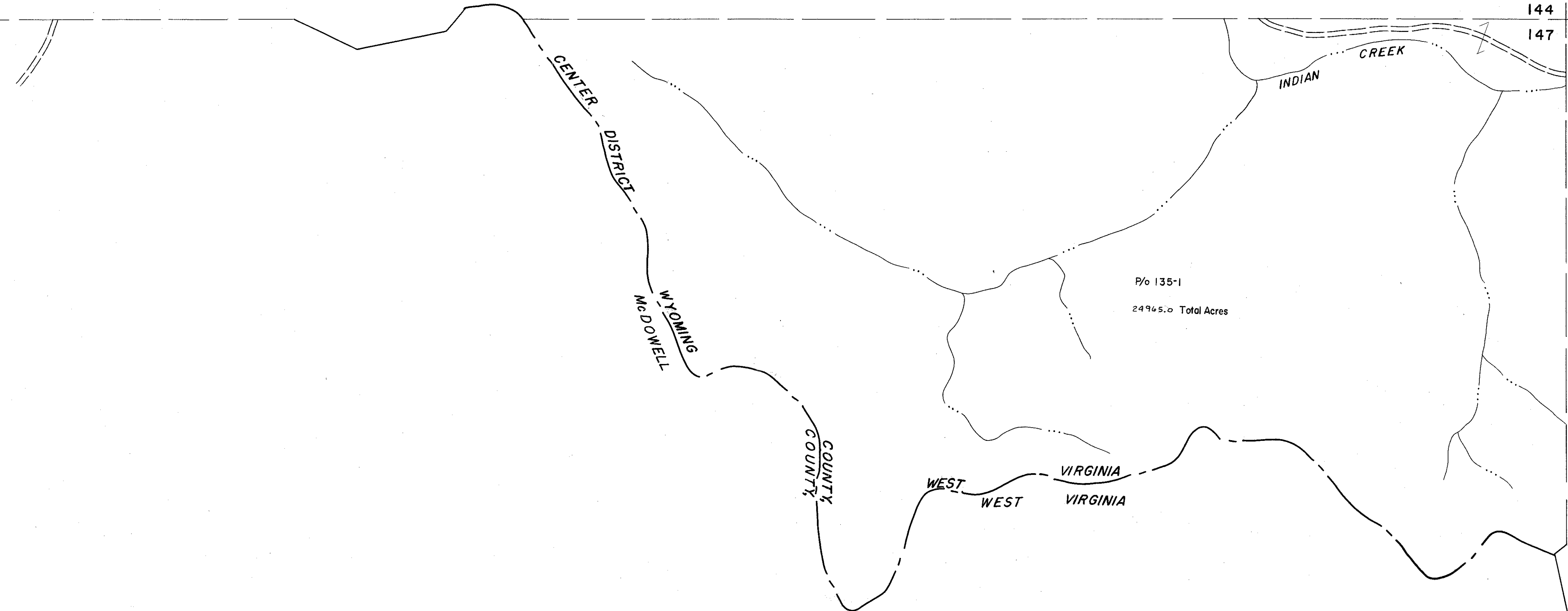

| 147

147 | 148

For Tax Purposes Only

Prepared by
MICHAEL BAKER, JR., INC.
Consulting Engineers
Rochester, Pennsylvania

Legend

Property line	—————	Original lot line	-----
Edge of pavement or roadway	=====	Deed lot number	(15)
Corporation line	-----	Parcel or index number	(99)
District line	-----	Improvement	o
County line	-----	Railroad	+ + + + +

Revisions

1	3-1-64	9	17
2	3/6/75	10	18
3	Revised to 7-1-81	11	19
4		12	20
5		13	21
6		14	22
7		15	23
8		16	24

KEY MAP

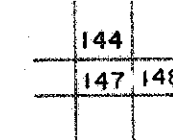

WYOMING COUNTY
STATE OF WEST VIRGINIA
Office of Assessor

DISTRICT

CENTER

SHEET NO:147

Date, Aerial Photography: November, 1962 Date, Map: April, 1963
Photo No: Scale: 1" = 400'