

145 | 146
148 | 149

146 |
149

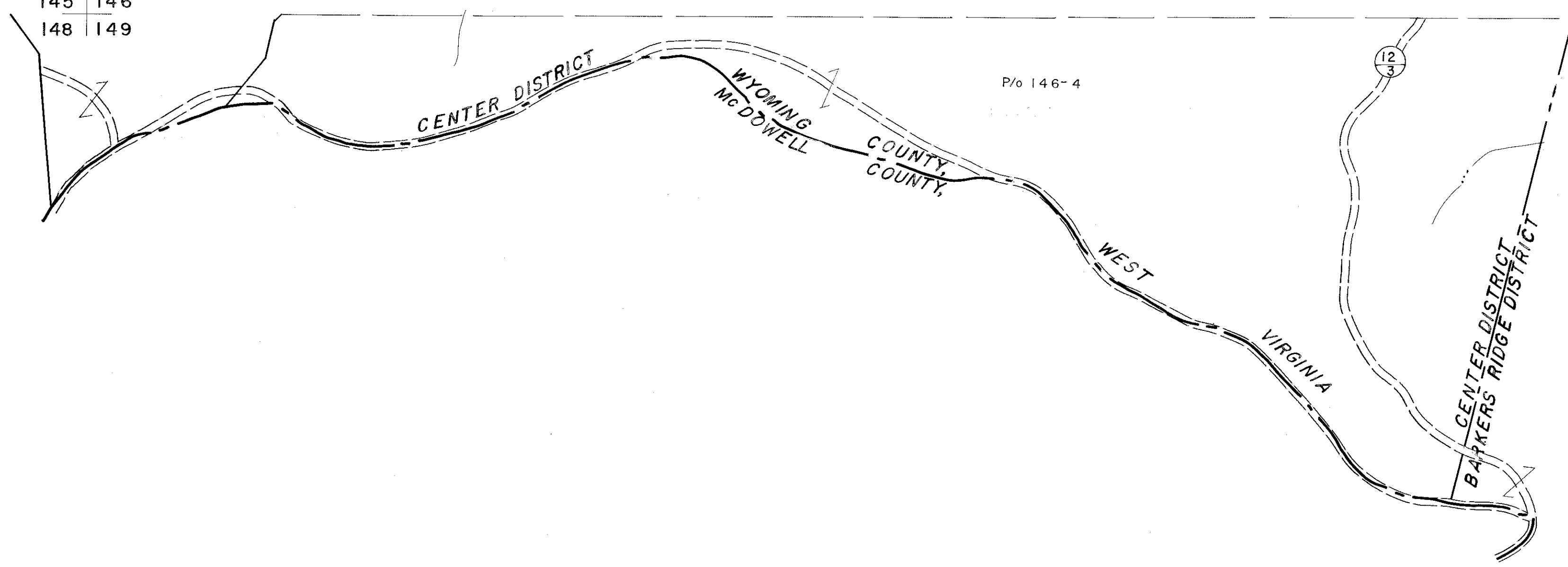

P/O 146-4

148 | 149

149

For Tax Purposes Only

Prepared by
MICHAEL BAKER, JR., INC.
Consulting Engineers
Rochester, Pennsylvania

Legend

Property line	—————	Original lot line	-----
Edge of pavement or roadway	———	Dead lot number	(15)
Corporation line	-----	Parcel or index number	(99)
District line	-----	Improvement	o
County line	-----	Railroad	+

Revisions

1	3-1-64	9	17
2	Revised by 7-1-81 DSW	10	18
3	SLS INC 11/16/98 DSW	11	19
4		12	20
5		13	21
6		14	22
7		15	23
8		16	24

KEY MAP

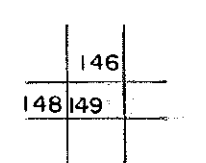

WYOMING COUNTY
STATE OF WEST VIRGINIA
Office of Assessor

DISTRICT

CENTER

SHEET NO: 149

Date, Aerial Photography: November 1962 Date, Map: April 1963
Photo No: Scale: 1" = 400'